



NEO-E Launch Monitor
Quick Start Guide

Nvisage

Tech

NOLO

GIES

What's Included



NEO-E Launch Monitor



Adaptor



Club Sticker



Alignment Tool



Outdoor Stand

Buttons



Cameras



Rear LED

Power Port

Power Button

USB-C Port

Ethernet Port

Power On/Off

To turn the power on or off, press and hold the red button on the back of the device for a second.

Connection

Data can be transferred to PC, mobile, and tablet devices. The Bluetooth function will be added in the near future. For more information on PC setup, please refer to the MURLIE User Manual.

Wi-Fi

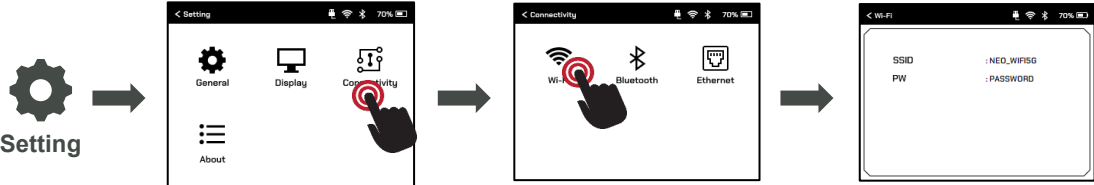

Ethernet

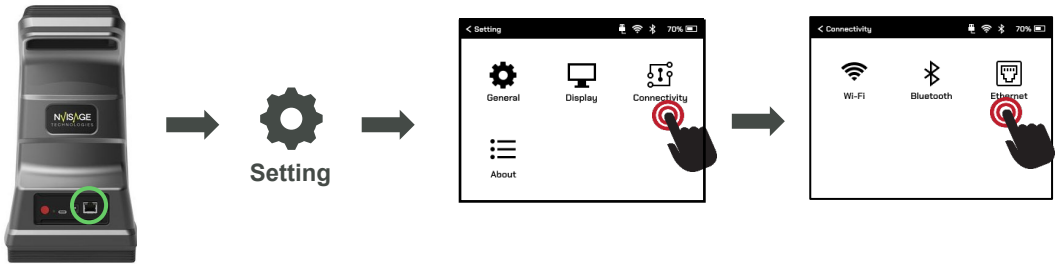

Sticker Attachment

Stickers must be attached to clubs in order to use the club data analysis features provided by NEO-E. Please refer to the below images and attach the sticker to the centerline of the groove. Detailed instructions for attachment can be found in the NEO-E User Manual.



LED Status

Front

Status	Color	Operation
Power on	Red	Increasing brightness
Power off	Red	Increasing brightness
Searching the ball	Red	Blinking
Checking ball placement	Green	Stable
Checking shot recognition	Blue	Blinking
Low battery	Orange	Blinking
Updating firmware	White	Blinking
Setting menu in operation	White	Stable



Rear

Status	Color	Operation
Charging	Red	Stable
Fully Charged	Green	Stable
Error	Orange	Stable

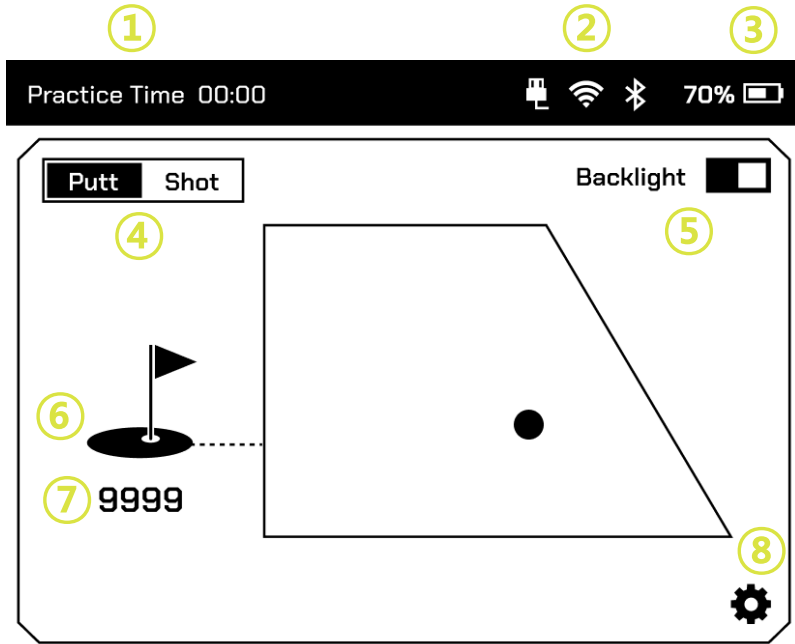

Main Screen: Practice Mode



No.	Description
①	Practice Time
②	Connection status: Wi-Fi  , Ethernet  , and Bluetooth 
③	Battery Status
④	PUTT/SHOT menus (Default: SHOT)
⑤	Backlight On/Off Button
⑥	Target Alignment settings
⑦	Number of Shot Recognitions (Default: 0 / Maximum: 9999)
⑧	Switches to the Setting screen.

Device Installation

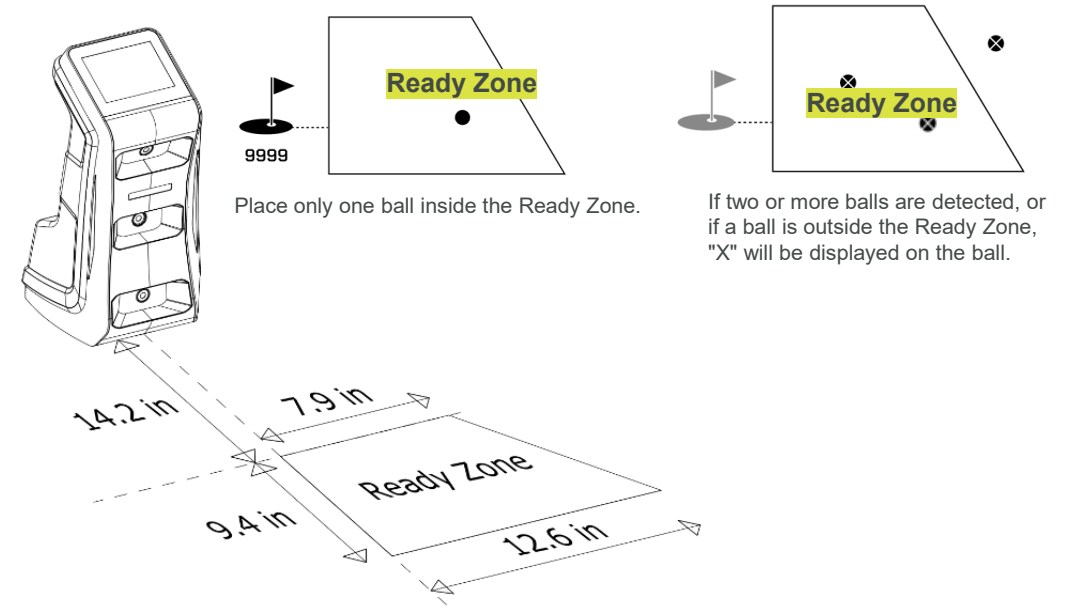

The **alignment tool** automatically corrects the ball angle for accurate recognition when the launch monitor cannot be placed on a flat surface.

Refer to the image on the right to position the alignment device, then tap **Target Alignment** on the **Practice Mode** screen to set the alignment information.

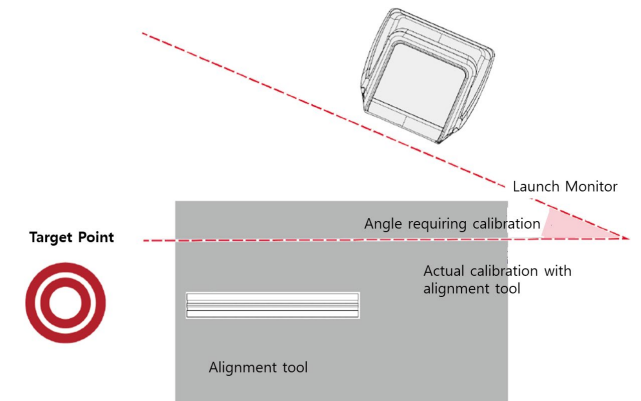

Data Settings

Shot Data Display

A user can customize which shot data is displayed on the screen.
For details on each data item, please refer to the user manual.

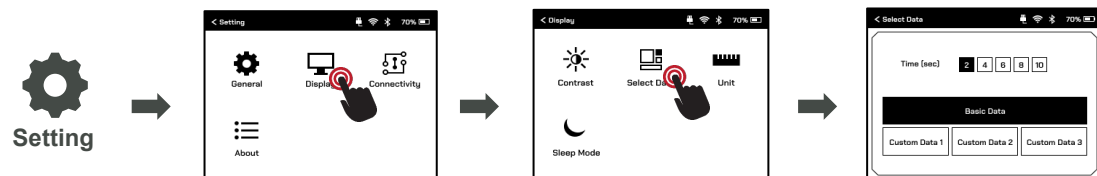

Shot Data Unit

Shot data can be displayed in the user's preferred units.
For details on each unit, please refer to the user manual.

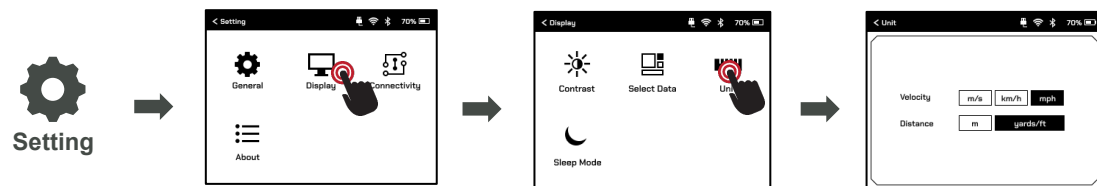

User Manual

For more detailed information about the product, please refer to the manual.

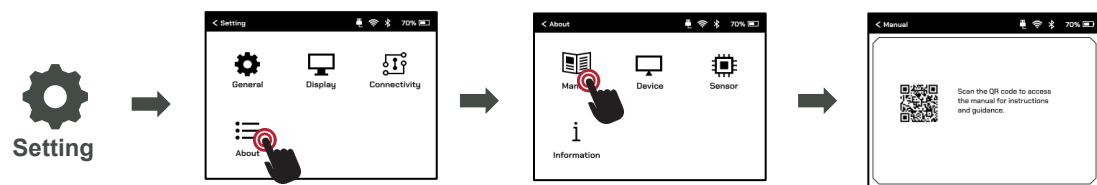

Handedness

When you set the dominant hand (right-handed/left-handed), the icons in Practice Mode will change accordingly.

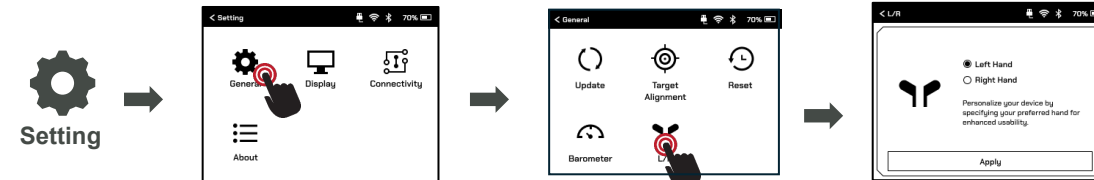

Barometer

The default setting is standard atmospheric pressure. To measure the actual atmospheric pressure, press the **Acquired** button.



Initialization

Setting information is initialized.

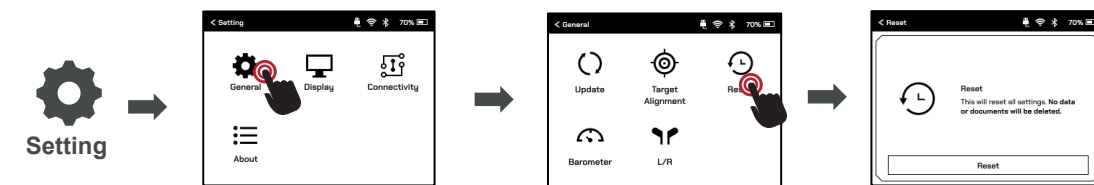

Caution and Maintenance

Power Supply Precautions

- Using an incorrect power supply may damage the product. Make sure to use the provided power adapter for charging. Using a different power adapter or charger may damage the device or cause safety hazards such as fire or electric shock.
- Before wiring the product to the power supply, ensure that the input power is turned OFF. Otherwise, it may cause damage to the product.

Installation Precautions

- Ensure that reflective surfaces such as mirrors or glass are not within the product's camera view, as this may lead to inaccurate measurements.
- The product may malfunction if it directly faces the sun during sunrise or sunset when the sun is near the horizon.
- Do not install or use the product in environments or locations like the following, as it may affect the accuracy of the measurements.
 - > Long grass or divots (damaged turf)
 - > Smooth or highly reflective surfaces
 - > Around fixed objects that may obstruct the camera's view
- This product uses an infrared sensor. Indoor lighting that interferes with infrared signals may cause the product to malfunction.

Product Maintenance

- When cleaning the product's surface, do not use solutions or diluents, as they may damage the product.
- Keep the product dry and always turn off the power when storing it.
- Do not store the product in extremely hot or cold locations. (Recommended temperature range: 14°F to 113°F)

Others

- This product uses a camera that is installed with precision. Do not drop, disassemble, or modify the product. There is a risk of damage to the device or electric shock.
- For safety, keep the product out of reach of children and pets.
- If liquid or foreign substances accidentally enter the device, do not use the product. Immediately turn off the power and contact the place of purchase for repair or replacement.
- Do not operate the product with wet hands, as there is a risk of electric shock.

